

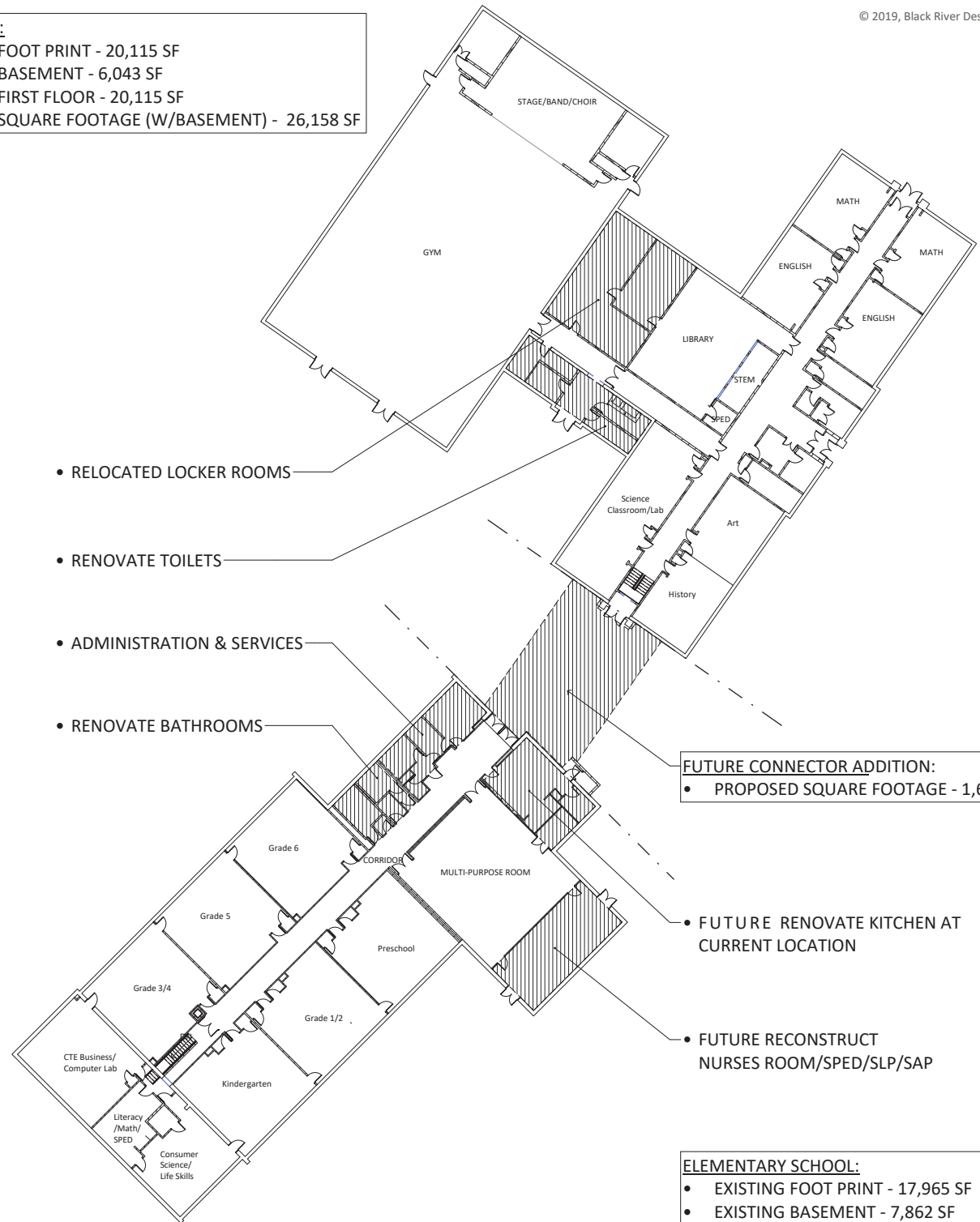

HIGH SCHOOL:

- EXISTING FOOT PRINT - 20,115 SF
- EXISTING BASEMENT - 6,043 SF
- EXISTING FIRST FLOOR - 20,115 SF
- EXISTING SQUARE FOOTAGE (W/BASEMENT) - 26,158 SF



- RELOCATED LOCKER ROOMS
- RENOVATE TOILETS
- ADMINISTRATION & SERVICES
- RENOVATE BATHROOMS

FUTURE CONNECTOR ADDITION:

- PROPOSED SQUARE FOOTAGE - 1,642 SF

- FUTURE RENOVATE KITCHEN AT CURRENT LOCATION
- FUTURE RECONSTRUCT NURSES ROOM/SPED/SLP/SAP

ELEMENTARY SCHOOL:

- EXISTING FOOT PRINT - 17,965 SF
- EXISTING BASEMENT - 7,862 SF
- EXISTING FIRST FLOOR - 14,398 SF
- EXISTING TOTAL SF (W/BASEMENT) - 22,260 SF

BASEMENT

MAIN FLOOR

PROPOSED PLANS (OPTION 2)